

F19 01082018

FLOORMASTER[®]



CORDED ECO VAC

Instruction Manual

Model Ref: F19

Introduction

Thank you for choosing the Floormaster Corded Eco Vac. All products brought to you by Floormaster are manufactured to the highest standards of performance and safety.

Before use, please read this manual carefully. It gives important instructions about safety, use and maintenance of your vacuum.

Remove all packaging material. You may wish to keep the packaging for future use or storage of your vacuum. Alternatively, dispose of accordingly.

Index

Important Safety Information	02
Product Overview	04
Before First Use	05
Installation Instructions	05
Dissassembly Instructions	06
Accessory Installation	07
Emptying the Dust Tank	08
Cleaning & Maintenance	09
Troubleshooting	12
Product Specification	12
Disposal Information	13

IMPORTANT SAFETY INFORMATION

WARNING - To reduce the risk of fire, electric shock, or injury:

- DO NOT run the vacuum over the power cable.
- DO NOT operate the vacuum if any part of it has been dropped or damaged.
- DO NOT disassemble or attempt to repair the vacuum cleaner.
- DO NOT vacuum any flammable or combustible liquids or use in areas where they may be present.
- DO NOT vacuum anything that is burning or smoking such as cigarettes, matches or hot ashes.
- DO NOT use the vacuum without the dust tank in place.
- DO NOT allow the vacuum to be used as a toy. Close attention is necessary when used near children, pets or plants.
- DO NOT unplug the vacuum by pulling on the power cord.
- DO NOT handle the vacuum with wet hands.
- DO NOT put any objects into openings.
- DO NOT use with any opening that is obstructed or blocked.
- DO NOT use with mains extensions, external timer or remote control systems.
- DO NOT operate the vacuum cleaner too close to heaters or radiators.
- Keep the dust tank free of excessive dust, lint, hair and larger debris that may reduce air flow, into and around the dust tank.

- Keep hair, loose clothing, fingers and all parts of the body away from opening and moving parts.
- Use extra care when cleaning on stairs.
- Only use the vacuum for its intended use.
- Keep the power cable away from any heated surfaces.
- Store your vacuum indoors, in a cool, dry area.
- Keep your work area well lit.
- Keep the end of the extension tube and the attachments away from your face and body when operating.
- Use only on dry surfaces.
- Using improper voltage may result in damage to the motor and possible injury to the user. Correct voltage is listed on the rating label located on the base of the vacuum.
- Keep the vacuum and its power cable out of the reach of children.
- To protect against a risk of electric shock, do not immerse any part of the vacuum in water or other liquids.
- This vacuum is intended for household use only. Follow all user instructions in this manual.
- Only use the manufacturer's recommended accessories as supplied.
- Before inserting the power cable into the wall outlet, make sure that your hands are dry.
- Before you start vacuuming, make sure your work area is free of sharp objects that might damage the vacuum filter.

PRODUCT OVERVIEW

1. Dual Speed On/Off Switch
2. Power Cable
3. Dust Tank Release Button
4. Suction Nozzle Release Button
5. Dust Tank
6. Telescopic Extension Tube
7. Brush Head
8. Crevice Tool Attachment
9. Upholstery Tool Attachment
10. Accessory Adapter
11. Handle
12. Dust Tank Top
13. Dust Tank Release Clip



BEFORE FIRST USE

WARNING: Please keep the plug out of the socket during assembly and disassembly.

Before using your vacuum for the first time, wipe all parts with a soft damp cloth.

INSTALLATION INSTRUCTIONS

Assembly Instructions

1. Slot the handle (11) into place on the dust tank (5) until it clicks securely into place (Fig 1).



2. Connect the accessory adapter (10) with the suction nozzle until it clicks securely into place (Fig 2).



3. Connect the telescopic extension tube (6) to the end of the accessory adapter (10) (Fig 3).

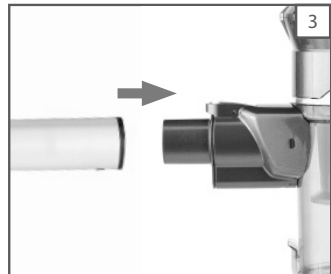

4. Connect the telescopic extension tube (6) into the brush head (7) (Fig 4).

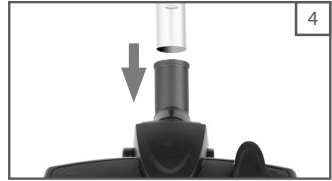

DISASSEMBLY INSTRUCTIONS

1. Remove the brush head (7) from the telescopic extension tube (6) (Fig 5).

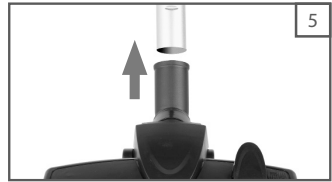

2. Remove the telescopic extension tube (6) from the accessory adapter (10) (Fig 6).

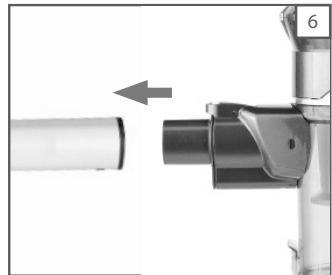

3. Remove the accessory adapter (10) from the suction nozzle by pressing the suction nozzle release button (4) (Fig 7).



4. Press the dust tank release button (3) and carefully separate the motor (12) from the handle (11) (Fig 8).



Note: Do not attempt to separate the motor (12) from the handle (11) without first ensuring the motor release button is pressed (3).

ACCESSORY INSTALLATION

1. The upholstery tool (9) can be connected to the end of the accessory adapter (10) directly (Fig 9).

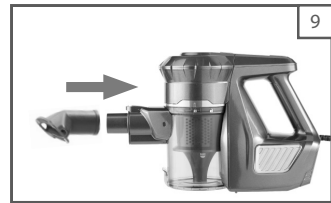

2. The crevice tool (8) can be connected to the end of the accessory adapter (10) directly (Fig 10).

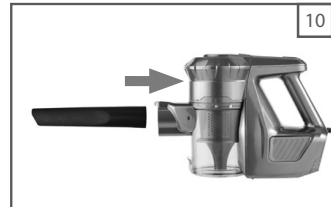

3. The upholstery tool (9) can be connected to the end of the telescopic extension tube (6) directly (Fig 11).

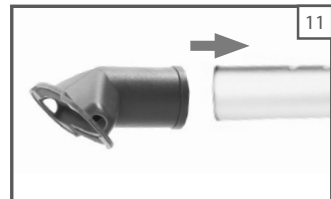

4. The crevice tool attachment (8) can be connected to the end of the telescopic extension tube (6) directly (Fig 12).



EMPTYING THE DUST TANK

1. Place the vacuum over your waste bin.
2. Open the dust tank (5) by releasing the clip (13) (Fig 13).



3. Gently shake the dust tank to empty all the waste (Fig 14).



CLEANING & MAINTENANCE

Cleaning the Filters

This must be done at least once a month (for heavier vacuum usage, clean the filter regularly).

1. Press the dust tank release button (3) to remove the handle (11) from the dust tank (5) (Fig 15).



2. Rotate the top of the motor (12) anti-clockwise until the mark on the motor lines up with the “🔒” symbol (Fig 16).

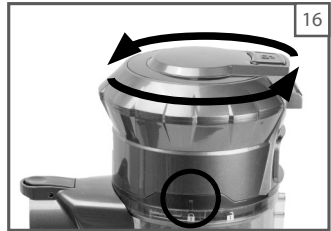

3. Remove the filter case, followed by the filter itself (Fig 17).



4. Remove the inner filter from the filter case, by rotating anti-clockwise (Fig 18).



5. Wash the filter and its case and rinse with water at least once per month (Fig 19).



Note: When clean, leave them to dry in a warm, well ventilated place. It is recommended to leave the filter for 24 hours to completely dry before reassembly.

6. To re-assemble the dust tank (5) and the dust tank top (12) together. Ensure that both parts join together using the line and the “🔒” symbol to correctly line up (Fig 20).



Clearing a Blockage

IF THE BRUSH HEAD BECOMES BLOCKED DURING USE, THE VACUUM WILL STOP.

1. Before checking for a blockage, remove the brush head (7) from the telescopic extension tube (6) (Fig 21).
2. Carefully pull any hair or fibre from the brush head (7).

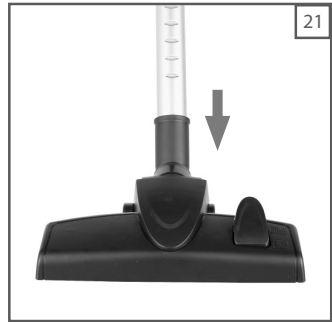

TROUBLESHOOTING

QUESTION	ANSWER
The vacuum isn't cleaning well	Empty the dust tank
	Check that the dust tank is correctly fitted
	Check the filter is correctly fitted
	Clean the filter
The vacuum cleaner is cutting out or isn't working as intended	Check the power cable for damage
	Clear debris from the motorised brush head
Unresponsive vacuum cleaner	Check the power connections
	Check the wall socket

PRODUCTSPECIFICATION

MODEL:	MAINS POWERED ECO VAC
Input Voltage	220~240V
Nominal Power	600W
Dust Tank Capacity	0.8L
Weight	1.8Kg
Power Cord	6M
Noise	≤ 75Db
Vacuum	≥ 15Kpa
Airflow	1.05 m ³ /min
Motor	Dual Speed

DISPOSAL INFORMATION

IMPORTANT INFORMATION FOR CORRECT DISPOSAL OF THE APPLIANCE IN ACCORDANCE WITH EC DIRECTIVE 2002/96/EC

At the end of its working life, the vacuum cleaner must NOT be disposed of as urban waste.

It must be taken to a special local authority differentiated waste collection centre or to a dealer providing this service.

Disposing of a household appliance separately avoids possible negative consequences for the environment and health deriving from inappropriate disposal and enables the constituent materials to be recovered to obtain significant savings in energy and resources. As a reminder of the need to dispose of household appliances separately, the product is marked with a crossed-out wheeled dustbin.

**For replacement filters call
0161 480 6204 or email
Info@floormaster.co.uk stating the catalogue
number**

FLOORMASTER[®]

Wellington Grove, Stockport
Cheshire, SK2 6RH



2011/65/EU

PRODUCER
IDENTIFICATION
MARK: JA1721X2