



VPLD-620N 07042017



# Double Cyclone

## Vacuum Cleaner

**Instruction Manual**  
Model Ref: VPLD-620N

Thank you for choosing the ValetPro by Giani Double Cyclone Vacuum Cleaner. All products brought to you by Giani are manufactured to the highest standards of performance and safety.

Before use, please read this manual carefully. It gives important instructions about safety, use and maintenance of your appliance.

Remove all packaging material. You may wish to keep the packaging for future use or storage of your appliance. Alternatively, dispose of accordingly.

## Index

Important Safety Information.....	02
Product Overview.....	04
Technical Information.....	04
Before First Use.....	05
Assembling Your Vacuum Cleaner.....	05
Operating Your Vacuum Cleaner.....	06
Cleaning The Dust Tank And Net Filters.....	08
Cleaning The HEPA Air Filters.....	09
Troubleshooting.....	10
After Sales Support.....	11
Product Guarantee.....	11
Disposal Information.....	12

## Important Safety Information

**WARNING** - To reduce the risk of fire, electric shock, or injury:

- This vacuum cleaner is for domestic use only. It should not be used for commercial purposes.
- Do not use outdoors or on wet surfaces.
- Only use the appliance for its intended use. Giani Ltd will not accept liability if the appliance is subject to improper use or in the event of failure to comply with these instructions.
- Do not handle the plug or vacuum cleaner with wet hands.
- This appliance can be used by children aged from 8 years and above and persons with reduced physical, sensory or mental capabilities, or lack of experience and knowledge, if they have been given supervision or instruction concerning the use of the appliance in a safe way and understand the hazards involved.
- Children must not play with this appliance.
- Cleaning and user maintenance shall not be made by children unless they are older than 8 years old and supervised.
- Keep the appliance and its cord out of reach of children less than 8 years of age.
- This product is not a toy.
- Do not use the vacuum cleaner if any parts appear to be faulty, missing or damaged.
- Do not use the vacuum cleaner if it has been dropped or damaged in any way.
- Check to ensure that electricity supply matches that shown on the rating plate.
- If the supply cord is damaged, it must be replaced by a qualified service agent in order to avoid a hazard.
- Ensure all parts including the dust tank are securely attached before using or moving the vacuum cleaner.
- Do not leave the vacuum cleaner unattended when connected to the mains supply or in use.
- Always unplug from the mains supply before carrying out any cleaning, performing user maintenance or changing accessories.
- Switch off the vacuum cleaner by the power switch before removing the plug from the mains supply.

- Do not disconnect the plug from the mains supply by pulling on the cord, switch it off and remove the plug by hand.
- Do not carry by the cable, use the cable as a handle, close a door on the cable or pull the cable around sharp edges or corners.
- Use of an extension cord with the appliance is not recommended.
- Keep hair, loose clothing, fingers and all parts of the body away from openings of the vacuum cleaner.
- Do not use with any of the openings blocked; keep free of dust, lint, hair and anything that may reduce airflow.
- Take extra care when vacuuming on the stairs.
- Do not use to pick up liquids.
- Do not use to pick up flammable or combustible materials.
- Do not use to pick up hot or burning objects such as a cigarettes, matches or hot ashes.
- Do not use to pick up building materials such as plaster, cement, brick dust etc - this will damage the motor.
- Do not use the vacuum cleaner to pick up large, hard or sharp objects such as glass, nails, screws, coins etc - This will damage the vacuum cleaner.
- Only use the attachments / accessories supplied with the product or recommended by Giani.
- Do not use without the dust tank and filters in place.
- Ensure that the dust tank is emptied and the filters cleaned regularly to maintain the performance of the vacuum cleaner.
- Do not store in direct sunlight or high humidity conditions.

## Product Overview

1. Cable retract button
2. Dust tank
3. Dust tank release button
4. Hose
5. Hose handle
6. Airflow adjustment button
7. Telescopic extension tube
8. On/off button
9. Air vent
10. Floor head brush
11. Crevice tool
12. Upholstery brush
13. Parking slot

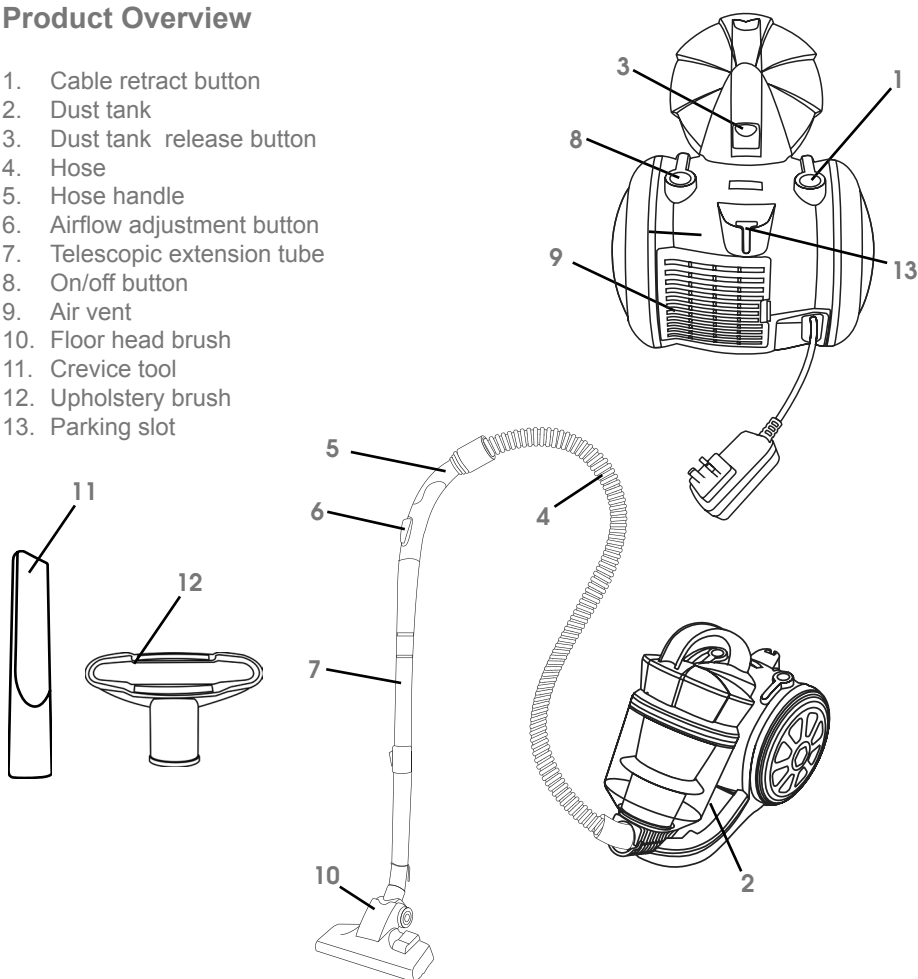

## Technical Information

Rated Power	700W
Suction Power	190W
Vacuum	15Kpa
Air Flow	1.9m <sup>3</sup> /Min
Dust Tank Capacity	2.0L
Noise	81dB

## Before First Use

- Before using your vacuum cleaner for the first time, wipe all parts with a soft damp cloth

## Assembling Your Vacuum Cleaner

DO NOT PLUG INTO THE MAINS ELECTRICITY SUPPLY UNTIL FULLY ASSEMBLED

1. Insert the hose end into the main suction hole (Fig 1). Push until you can hear the 'Click' sound to ensure it has been assembled properly. To detach the hose press the release button

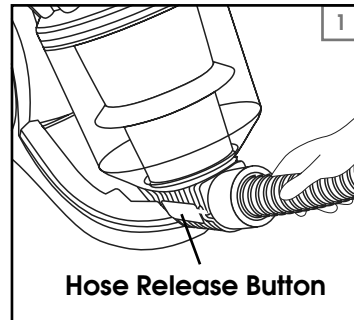

2. Push the hose handle into the upper part of the telescopic extension tube and the floor head brush into the lower connection of the telescopic extension tube (Fig 2).

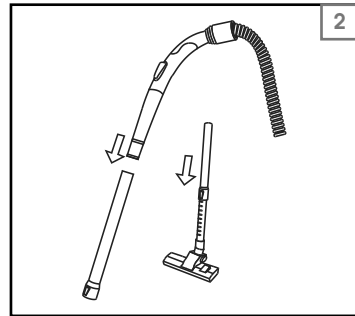

3. Push forward on the telescopic extension tube adjustment button to adjust until the desired tube length (Fig 3).

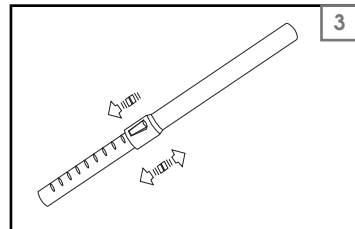

- Put the dust tank onto the main body and press down until you hear the 'Click' sound to ensure the dust tank is properly assembled into place (Fig 4).

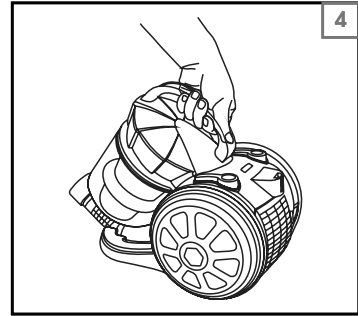

## Operating Your Vacuum Cleaner

- Attach the desired nozzle onto the vacuum cleaner
- Pull the power cord out of the vacuum cleaner until the yellow mark is visible (Fig 5.)

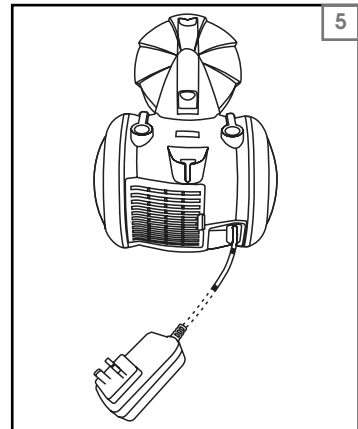

- Switch on the vacuum cleaner using the On/Off switch (Fig 6).

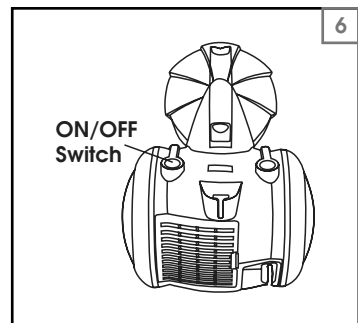

1. To change the floor head brush position press the button on the brush.

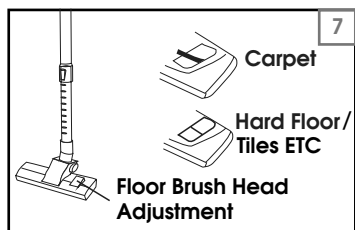

2. You can adjust the suction by moving the airflow adjustment button on the hose handle (to clean curtains etc.) (Fig 8).

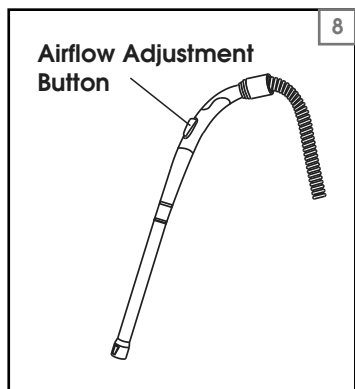

3. When you have finished vacuuming turn off the vacuum cleaner and retract the power cable (Fig 9).

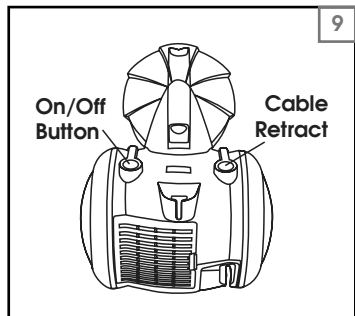

3. To store the vacuum cleaner insert the floor head brush into the parking slot on the back of the vacuum (Fig 10)

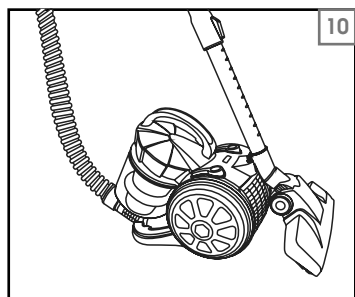



## Cleaning The Dust Tank And Net Filter

1. Press the dust tank release button (a). Remove dust tank (b) (Fig 11).

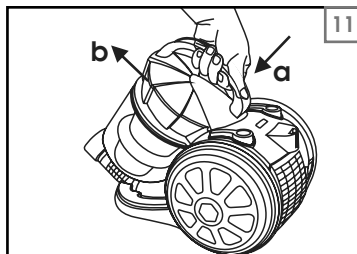

1. Unlock the dust tank and net filter by turning the cover counter clockwise (Fig 12).

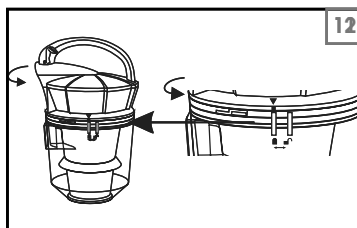

2. Lift the dust tank and net filter away from the vacuum cleaner (Fig 13). You will now be able to empty the dust tank.

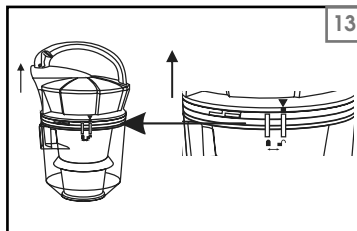

3. Holding the handle and the base turn counter clockwise to release the net filter (Fig 14).

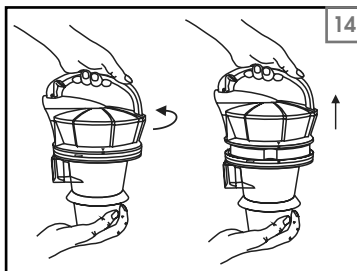

4. To maintain the performance of the vacuum cleaner we recommend to empty the dust tank regularly. Please do not allow the dust to reach beyond the MAX mark on the dust tank (Fig 15)

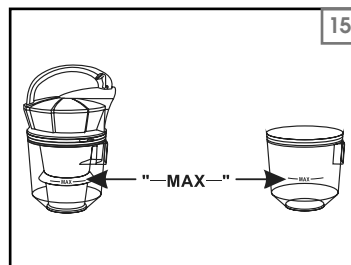

5. Wash the HEPA filter under running water every 8 weeks (Fig 16). Wait for it to be completely dry before reattaching to the vacuum cleaner. To avoid damaging the filter do not brush or rub when cleaning.

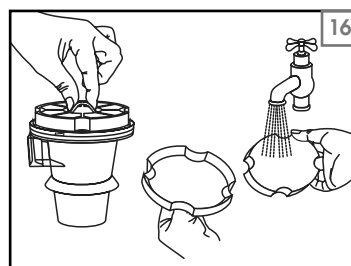

## Cleaning the HEPA Air Filter

1. Open the air outlet by pressing on the catch on the right hand side (Fig 17)
2. Remove the HEPA air filter from the inside of the vacuum cleaner (Fig 18).

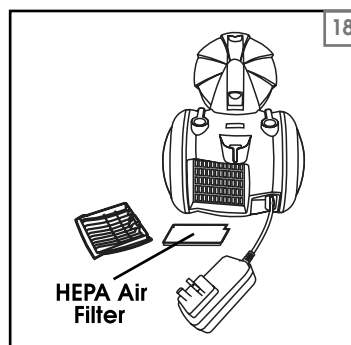
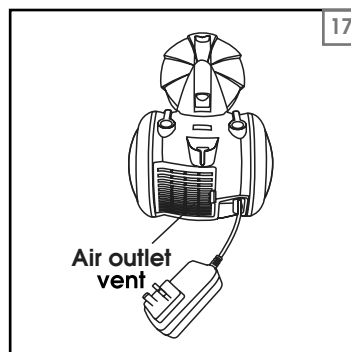

3. Wash the HEPA filter under running water every 8 weeks (Fig 19). Wait for it to completely dry before reattaching to the vacuum cleaner. To avoid damaging the HEPA filter do not brush or rub when cleaning.

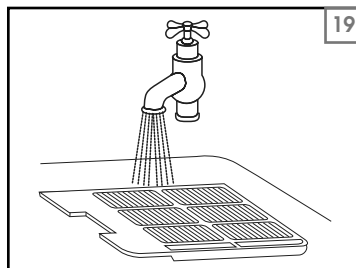

## Troubleshooting

Problems	Solutions
Not working	<ol style="list-style-type: none"> <li>1. Check if the plug is inserted into the socket properly. If necessary, unplug and re-plug again.</li> <li>2. Check if the socket has power supply.</li> <li>3. Check if the product is switched off.</li> </ol>
Low suction	<ol style="list-style-type: none"> <li>1. Check if the floor head brush or telescopic extension tube has been blocked. If so, please clean the blockage immediately.</li> <li>2. Check if the filters are clear of dust, clean the filters regularly to ensure the best performance</li> </ol>
Abnormal motor noise	<ol style="list-style-type: none"> <li>1. Stop using immediately</li> <li>2. Check for any blockage in floor head brush / hose or telescopic extension tube. Clear any blockage immediately.</li> </ol>

## After Sales Support

If you need help using your Vacuum Cleaner, please contact Giani Ltd:-

- Telephone: 0161 480 6204
- Email: [info@gianiuk.co.uk](mailto:info@gianiuk.co.uk)
- Website: [www.gianiuk.co.uk](http://www.gianiuk.co.uk)  
(Replacement instruction manuals are available to download).

## Product Guarantee (UK Only)

If your appliance ceases to function within 1 year from the date of purchase, the retailer will replace it free of charge, provided:

- You have not misused, neglected or damaged it
- It has not been modified (except by Giani Ltd)
- It was not purchased second hand
- It has not been used commercially
- You have not fitted a plug incorrectly
- You can supply proof of purchase, indicating the price you paid and where and when the appliance was purchased.

This guarantee does not affect your statutory rights.

## Disposal Information

IMPORTANT INFORMATION FOR CORRECT DISPOSAL OF THE APPLIANCE IN ACCORDANCE WITH EC DIRECTIVE 2002/96/EC

At the end of its working life, the appliance must NOT be disposed of as urban waste. It must be taken to a special local authority differentiated waste collection centre or to a dealer providing this service.

Disposing of a household appliance separately avoids possible negative consequences for the environment and health deriving from inappropriate disposal and enables the constituent materials to be recovered to obtain significant savings in energy and resources. As a reminder of the need to dispose of household appliances separately, the product is marked with a crossed-out wheeled dustbin.



**Are you having problems with your cleaner?  
Do you require a replacement filter?  
Do you require spare parts?**

Before returning this item to your place of purchase  
Please contact Giani at:

Email - **info@gianiuk.co.uk**

Website - **www.gianiuk.co.uk**



Giani Limited - SK2 6RH  
**info@gianiuk.co.uk**