



WC0875 27022018



Bluetooth Speaker

Instruction Manual
Model Ref: WC0875

INTRODUCTION

Congratulations on choosing to buy an Audial product. All products brought to you by Audial are manufactured to the highest standards of performance and safety.

Before use, please read this manual carefully. It gives important instructions about safety, use and maintenance of your bluetooth speaker.

We hope you enjoy using your purchase for many years to come.

Remove all packaging material. You may wish to keep the packaging for future use or storage of your bluetooth speaker. Alternatively, dispose of accordingly.

CONTENTS

Introduction.....	1
Important Safety Information	2
Product Overview	4
Functions	5
Charging the speaker	6
Product Specifications	7
Troubleshooting	8
Disposal Information.....	9

IMPORTANT SAFETY INFORMATION

This handbook contains basic safety precautions and instructions for use. Please read the manual carefully before using the bluetooth speaker to reduce the risk of product damage and personal injury.

- **DO NOT** expose the bluetooth speaker to high temperatures, direct sunlight, moisture, rain or a highly dusty environment.
- **DO NOT** use the bluetooth speaker in prohibited areas (ie; airplanes).
- **DO NOT** use the bluetooth speaker whilst driving or walking.
- **DO NOT** dispose of the bluetooth speaker in a fire to avoid explosion.
- **DO NOT** disconnect the bluetooth speaker from the USB power supply by pulling on the cord.
- **DO NOT** attempt to disassemble the product, or use alcohol, thinners or benzene to clean the Bluetooth speaker as this will cause damage to the unit.
- **DO NOT** disassemble, repair or modify the Bluetooth speaker by yourself. Refer servicing to qualified personnel only.
- Never subject any heavy impact on the bluetooth speaker such as dropping or shaking.
- Keep away from magnetic sources.
- It is not recommended to use the speaker at a high volume for an extended period of time as this may cause damage to your hearing.
- Once the casing has been tampered with the company shall not be liable for any resulting damages or faults.
- Clean with a dry cloth only. Make sure the bluetooth speaker is turned off before and do not use liquid or

abrasive cleansers.

- Only use this bluetooth speaker for its intended domestic use. JDW will not accept any liability if the bluetooth speaker is subject to improper use or failure to comply with these instructions.
- Keep the bluetooth speaker and its power supply cord away from heat or sharp edges that could cause damage.
- Use of an extension cord with the bluetooth speaker is not recommended.
- This bluetooth speaker should not be operated by means of an external timer or separate remote control system.
- Keep the bluetooth speaker away from flammable materials.
- Avoid dropping the Bluetooth Speaker.
- The company reserves the right to improve the product specification and design. The information is subject to changes without prior notice.
- This Bluetooth speaker has no waterproof function.
- All pictures in this manual are just for your reference only.
- Kindly read this user manual before using the bluetooth speaker carefully, and keep it for future reference.

PRODUCT OVERVIEW

- ① Volume Increase
- ② Next Track
- ③ Previous Track
- ④ Volume Decrease
- ⑤ Call & Play/Pause
- ⑥ 3.5mm Aux Input
- ⑦ On/Off Switch
- ⑧ Micro USB Charging Port
- ⑨ TF/SD Card Slot

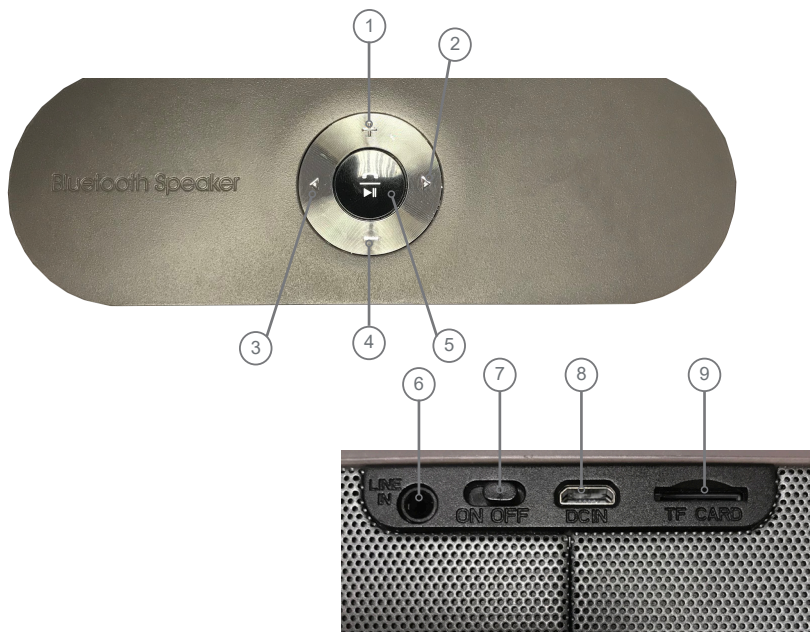

In the box:

- | | |
|-----------------------------|-----|
| 1. Bluetooth Speaker | x 1 |
| 2. Micro USB Charging Cable | x 1 |
| 3. 3.5mm AUX cable | x 1 |
| 4. User Manual | x 1 |

3.5mm
AUX cable



Micro USB
Charging Cable



FUNCTIONS

TF/SD CARD

- Insert the micro SD/TF card into the micro SD/TF card slot (9). When switched on with the SD/TF card in place, the speaker will announce “now you are in TF mode”. Audio will automatically play. WAV and MP3 media are supported.

AUX Mode

- Insert into the aux input slot (6). When switched on with the micro SD/TF card in place, the speaker will announce “now you are in Aux mode”. Use your bluetooth speaker to play music through the speaker using the provided AUX cable.

Battery

- When the battery is running low, the speaker will announce “Battery low, please recharge”. When charging, a red light will illuminate above the charging port when charging.

USB mode

- When connected to a PC with the micro USB cable, the speaker will announce “USB Bluetooth speaker”. Here you can charge the speaker or access your files stored on an inserted micro SD/TF Card.

Bluetooth mode

- You can wirelessly connect and control the media you are playing through the speaker.
- When turning on, the Bluetooth speaker will automatically enter Bluetooth mode. The speaker will announce “the Bluetooth bluetooth speaker is ready to pair”. At this point the green LED light at the back of the unit will flash.
- Connect a bluetooth bluetooth speaker to the bluetooth speaker by pairing with the code WC0875.
- Once connected successfully, the speaker will announce “the Bluetooth bluetooth speaker is connected successfully”. At this point the green LED light at the back of the unit will be a stable light.
- When audio is being played through the speaker, the green

indicator light will flash blue and green.

Phone

- When a mobile phone is connected to the speaker, it can play audio through the speaker of the phone call. To answer the call, press the “call & play/pause button (5)” on top of the Bluetooth speaker to answer the call.
- During the ring process, the speaker will read out the number that is currently calling.
- To hang up, simply press the “call & play/pause button (5)” located on the top of the Bluetooth speaker.

CHARGING THE SPEAKER

To charge the Bluetooth speaker, connect the supplied micro USB cable to the micro USB charging port (8) and the other end to your computer or USB charging bluetooth speaker.

Make sure you charge your Bluetooth speaker for at least 4 hours before using it for the first time.

PRODUCT SPECIFICATIONS

Bluetooth® Version	V 4.2.
Working Distance	Up to 10 meters in open space.
Speaker Output	5W * 2
Frequency Response	100Hz - 20kHz
Charging Input	DC 5 V
Playback Time	Approx. 3-4 hours
Charging Time	Approx. 4-5 hours
Rechargeable Battery	2000mAh
Unit Size	196 x 79 x 79mm

Note: Battery life & charging time may vary, based on usage & types of bluetooth speakers used. The product design and specifications may be changed subject of without prior notice.

TROUBLESHOOTING

Problem	Solution
Speaker will not turn on.	Make sure your speaker has not run out of battery. Connect it to a power source via the included USB cable.
Pairing is unsuccessful after multiple attempts Playback Time	Check if the green flashing bluetooth indicator light is on. If the indicator light is off, please switch the power button to turn on the unit. If the Bluetooth light still doesn't come on after switching the power button to ON, please charge the unit.
	Unplug any micro SD/TF memory cards/ Auxiliary cables.
	Ensure that the speaker is not already connected to another bluetooth speaker.
	Restart your pairing bluetooth speaker.
Interference or static during playback	Avoid using the speaker between concrete or other building structures that may interfere with the signal.
	Please check the battery level of the unit (via the paired bluetooth speaker) and charge if necessary.

DISPOSAL INFORMATION

IMPORTANT INFORMATION FOR CORRECT DISPOSAL OF THE PRODUCT IN ACCORDANCE WITH EC DIRECTIVE 2002/96/EC.

At the end of its working life, the product must not be disposed of as urban waste. It must be taken to a special local authority differentiated waste collection centre or to a dealer providing this service.

Disposing of a house hold product seperately avoids possible negative consequences for the environment and health deriving from inappropriate disposal and enables the constituent materials to be recovered to obtain significant savings in energy and resources. As a reminder of the need to dispose of products seperately, the product is marked with a crossed-out wheeled dustbin.





AUDIAL

Wellington Grove,
Stockport, SK2 6RH



RoHS

2011/65/EU